

ENGLANDS



28a Trident Court Savoy Close

Harborne, Birmingham, B32 2HD

£107,000





PROPERTY DESCRIPTION

A second floor studio apartment set in a cul-de-sac location. Briefly comprising: hallway, living room with bedroom area and fitted cupboards, kitchen, bathroom, double glazing and electric heating where specified. Garage in separate block.

Trident Court is conveniently located in Savoy Close which leads off Tennyson Road, in turn leading between Court Oak Road and War Lane/Northfield Road. It is readily accessible to the Queen Elizabeth Medical Centre, the University of Birmingham and Harborne Leisure Centre, as well as excellent amenities around Harborne High Street and regular transport services leading through to comprehensive City Centre leisure entertainment and shopping facilities.

The property itself is situated on the second floor of this low rise purpose-built block and enjoys a pleasant rear outlook. It is set in landscaped grounds having lawns, trees and some communal parking facilities. Approach is via a communal entrance hall with security answerphone system.

An internal inspection is essential and thoroughly recommended to fully appreciate the accommodation which



Tel: 01214271974

28a Trident Court Savoy Close



There is a good sized storage cupboard situated adjacent to the front door, designated for the exclusive use of the occupant. Entrance door leads into:

ENTRANCE HALLWAY

Having ceiling light point, security answerphone, electric heater and recessed coat hanging area.

LIVING ROOM/BEDROOM

5.88m max x 3.27m max (19'3" max x 10'8" max)

Having UPVC double glazed window overlooking the gardens, wooden style flooring, wall-mounted electric heater, recessed storage area and two ceiling light points. Fitted storage cupboards.

KITCHEN

2.15m max x 2.15m max (7'0" max x 7'0" max)

Having UPVC double glazed window, partial tiling to walls, a range of base and wall units with worktop over, single bowl sink drainer with mixer tap over, plumbing for washing machine, electric hob and tiled flooring.

BATHROOM

2.52m max x 2.14m max (8'3" max x 7'0" max)

Having ceiling light point, tiling to two walls, fully tiled shower cubicle with wall mounted electric shower, low flush WC and hand wash basin. Tiled flooring, extractor fan, built in storage cupboard and further cupboard housing water tank.

OUTSIDE

Garage in separate block.

ADDITIONAL INFORMATION

Tenure: We are advised the property is leasehold - It will be 990 years on completion. A service charge of £996.00 per annum and a ground rent of £10 per annum.

Council Tax Band: A

There are two communal drying rooms.

Vendor is in the process of renewing the lease, will have 990 years on completion.

ROAD MAP



ENERGY EFFICIENCY GRAPH

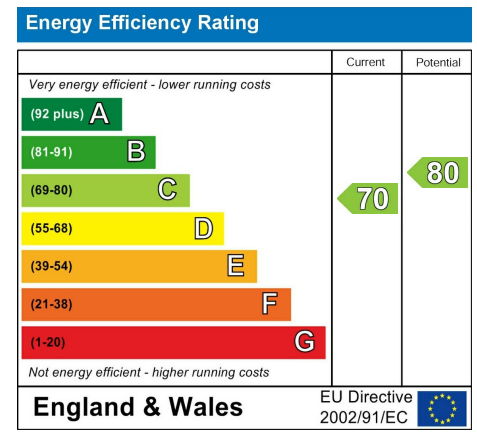

FLOOR PLAN

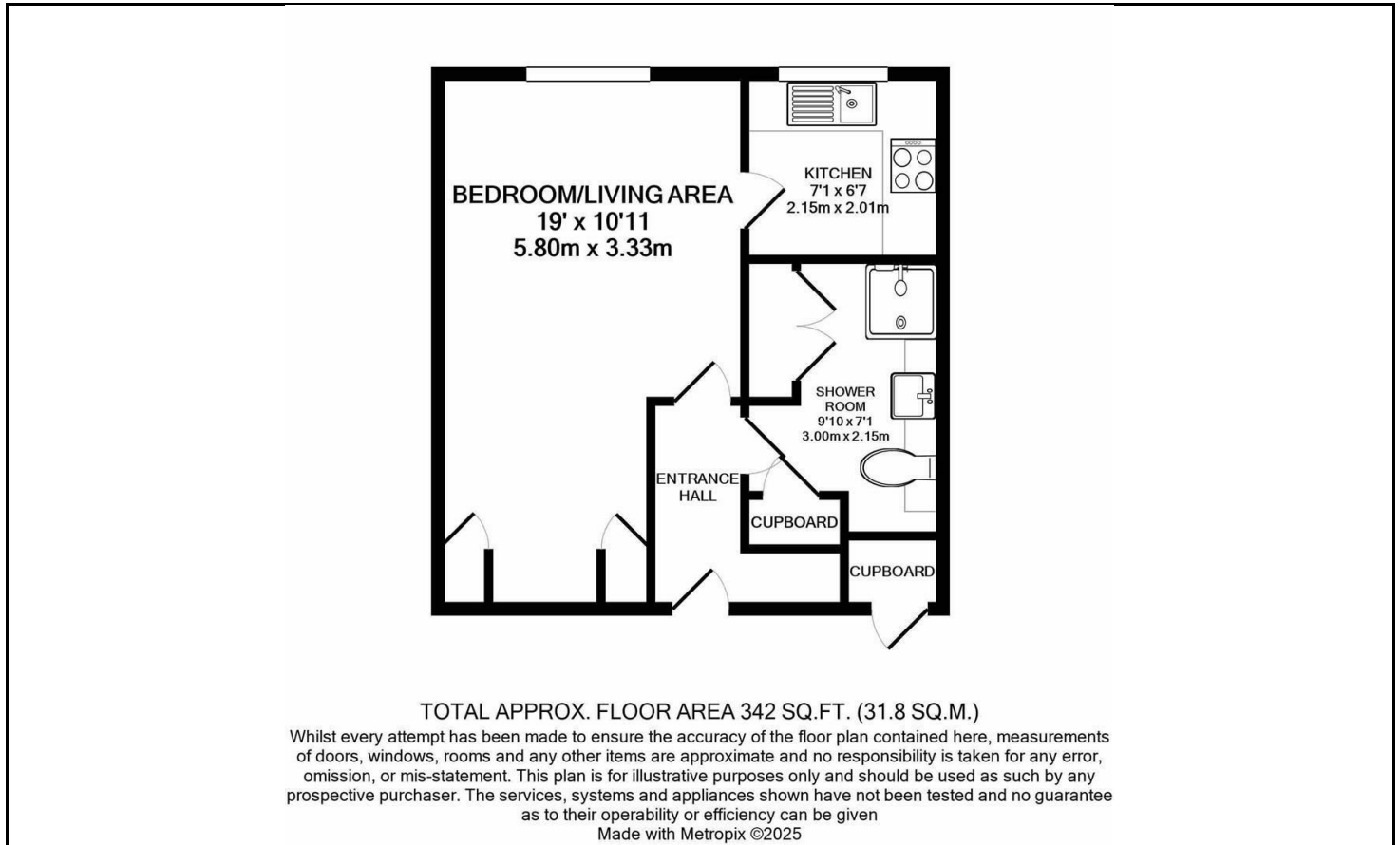

DISCLAIMER NOTICES

"The agent has not tested any apparatus, equipment, fixture, fittings or services, and so does not verify they are in working order, fit for their purpose, or within ownership of the sellers, therefore the buyer must assume the information given is incorrect. Neither has the agent checked the legal documentation to verify legal status of the property or the validity of any guarantee. A buyer must assume the information is incorrect, until it has been verified by their own solicitors. The measurements supplied are for general guidance, and as such, must be considered as incorrect. A buyer is advised to re-check the measurements themselves before committing themselves to any expense. Nothing concerning the type of construction, or condition of the structure is to be implied from the photograph of the property. The sales particulars may change in the course of time, and any interested party is advised to make final inspection of the property prior to exchange of contracts."

Misrepresentation Act 1967

"These details are prepared as a general guide only and should not be relied upon as a basis to enter into a legal contract, or to commit expenditure. An interested party should consult their own surveyor, solicitor or other professional before committing themselves to any expenditure or other legal commitments. If any interested party wishes to rely upon any information from the agent, then a request should be made, and specific written confirmation can be provided. The agents will not be responsible for any verbal statement made by any member of staff, as only a specific written confirmation should be relied upon. The agent will not be responsible for any loss other than when specific written confirmation has been requested."

These particulars, whilst believed to be accurate are set out as a general outline only for guidance and do not constitute any part of an offer or contract. Intending purchasers should not rely on them as statements of representation of fact, but must satisfy themselves by inspection or otherwise as to their accuracy. No person in this firm's employment has the authority to make or give any representation or warranty in respect of the property.